

# woollypetals Patchwork Tote



This pattern may not be sold or distributed without the written permission of the author. You may use this pattern to make and sell on a small handmade business scale with credit of pattern to the author. Feel free to kit and use in a class just noting woollypetals as the site where available and Kristin Rauch as the author.

# woollypetals Patchwork Tote

## Patchwork Tote measures 20"w X 16"t x 8"d

This tote is a quick and easy make and holds a ton! It's big.

The key to a bag that isn't floppy is the Cotton Duck Cloth lining (it needs to be stiff). The stitching up the sides helps with the bag holding its shape as well. I get my Cotton Duck Cloth on the bolt from Joann Fabrics. If you don't use a stiff Cotton Duck Cloth or wish to use a quilting cotton, I recommend adding a layer of Fusible Foam to the lining pieces. Just cut the foam a  $\frac{1}{2}$ " smaller than the lining pieces so it doesn't fill the seams and fuse it  $\frac{1}{4}$ " in from all sides.

This bag is easy to size up and down by changing the size of the squares. Just remember to change the size of the lining pieces too. I.e. multiply the finished size of the square by the amount of squares wide or tall in each panel and then add a  $\frac{1}{2}$ " total for the seam allowance. For 3" squares; for the front and back panels that are 4 squares tall by 5 squares wide.  $3t \times 4w = 12 + \frac{1}{2}" = 12 \frac{1}{2}"$  tall.  $3 \times 5 = 15" + \frac{1}{2}" = 15 \frac{1}{2}"$  wide so your front and back lining pieces would be  $12 \frac{1}{2}"$  tall X  $15 \frac{1}{2}"$  wide.



## Fabrics and Materials:

66 – 4.5" squares (sub in stars from the "To the Stars" pattern for squares as desired)

1 yd of Cotton Duck Cloth (assumes non directional)

2 yds of SF101 (or comparable fusible light weight interfacing)

1 yd Fusible Fleece

38"-40" Webbing for handles

**Cut Lining Pieces:** From Duck Cloth, SF101, and Fusible Fleece.

2 – 20.5" X 16.5"

2 – 8.5" X 16.5"

1 – 20.5" x 8.5"

A great way to cut the fusible interfacing is fuse the patchwork panel to the interfacing and then cut out around it.



## Sew Patchwork Panels: ¼" seam allowance.

Use the 4.5" squares

Make two panels: 1 for each the front and back that are 5 squares wide by 4 squares tall.

Make two panels for the sides that are 2 squares wide by 4 squares tall.

Make the final panel for the bottom that is 2 squares deep by 5 squares wide.

4.5" squares laid out for front panels



front panel sewn up



---

## Prep Panels: Use SF101, and Fusible Fleece.

Once panels are sewn iron SF101 to the back of each panel using the corresponding size. Then iron the fusible fleece to the back of the panels with SF101 for a double interfacing to give it stability.

2 side panels

2 front/back panels



1 bottom panel

---

## Sew Bag Exterior and Interior: ¼" seam allowance.

**\*See Note (Pg. 5) about bag handles before starting.**

**Step 1:** On the side panels, mark a dot ¼" in from the bottom and sides in each bottom corner. Do the same for the bottom panel on all four corners.



**Step 2:** With right sides together sew the 8.5" bottom of the side panel to the 8.5" side of the bottom panel, starting from the dot in one corner, and stopping at the dot in the opposite corner. Make sure to back stitch at the beginning and end of the seam but to not sew past the dot.



**Step 3:** Repeat with the opposite side panel, sewing it to the opposite end of the bottom panel.

(Sewing the side and bottom panels together until ¼" at the ends allows the side and bottom panel to turn and fit the bag front and back without bunching).

---

**Step 4:** With right sides together align the top of the front panel with the top of a side panel and pin down the side of the bag to secure the panels together. Continue pinning across the bottom and continue up the last side as

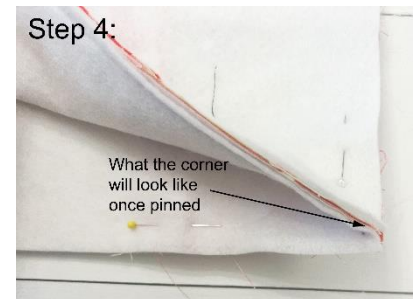
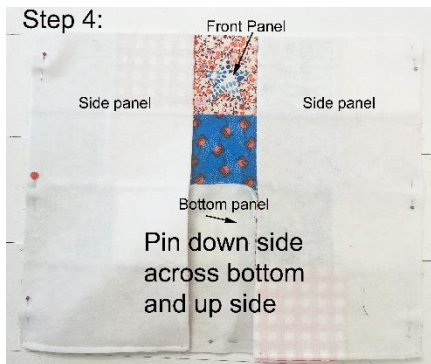

well.

---

**Step 5:** Sew down one side and across the bottom and back up the opposite side, back stitching at the beginning and end. >> When you get to a corner, stop ¼" away (where side panel and bottom panel meet) with needle in down position, lift presser foot and turn project to bottom side. Once aligned on the bottom, lower the presser foot and start sewing to the next corner. Then repeat for the final side. I sometimes will back stitch at the corners too. Repeat to sew on the back panel.

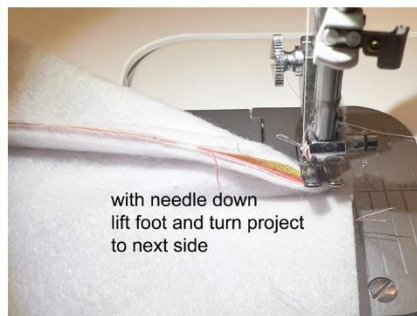
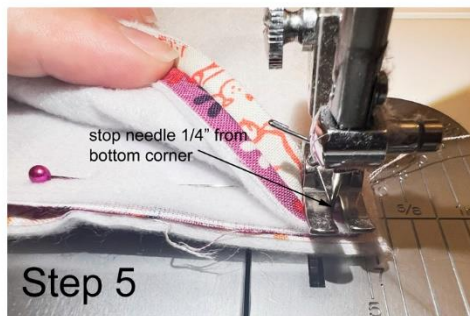

---

**Step 6:** Sew the lining repeating steps 1-5. For the lining leave a 6" opening along the middle of one side of the bottom panel.



## Sew Handles on:

**\*Note:** You can do this step now, or before you sew the Front and Back panels to the sides and bottom in above section if that's easier.

Cut your webbing into (2) 19"-20" pieces.

With the front panel right side facing up lay the handles aligned with the outer edge of the 2<sup>nd</sup> square from the outside. See picture for placement. Lay at a 45 degree angle. If your webbing is not double sided place right side facing the fabric panel. Baste the webbing on about 1/8" from the edge. I recommend sewing several rows of stitches on top of each other over the webbing for extra durability.



## Sew Lining and Bag Exterior together:

**Step 1:** With the exterior of the bag facing out take the lining with the right side facing in and place the exterior of the bag inside the lining. This will achieve the right sides of the fabric facing each other for sewing. Make sure the handles are tucked between the right sides of the lining and the exterior. You shouldn't be able to see them.

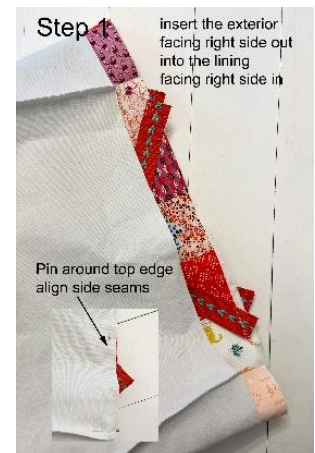

**Step 2:** Sew along the top edge around the whole bag using a 1/4" seam allowance. Make sure to align all the patchwork seams and the corners. Pin if necessary. Trim the handles ends to seam allowance.

**Step 3:** Turn the bag right side out through the opening on the lining bottom you left when sewing the lining piece together. You will have to pull everything through the hole and then stuff the lining with right side facing out back into the exterior shell of the bag so it looks like a regular tote with the exterior fabric facing out, and the lining fabric on the inside and all seams are hidden.



Pull the bag through the hole in the lining



**Step 4:** Pin the exterior and lining together along the top edge and stitch along around about  $\frac{1}{4}$ " in from the edge.

---

**Step 5:** Sew up the opening in the lining. I love to use an invisible ladder stitch and sew it up by hand. But feel free to use a machine just remember to turn the raw edges inward so you have a nice finish.

---



**Step 6:** Take a corner and fold along the seam tucking the lining into the fold as well and stitch along the side top to bottom as far as you can go about  $\frac{1}{4}$ " away from the fold. You should be able to get within  $\frac{1}{4}$ "- $\frac{1}{2}$ " of the bottom. This seam up the side gives the bag added stability to sit up and not be floppy. Repeat on all 4 corners.

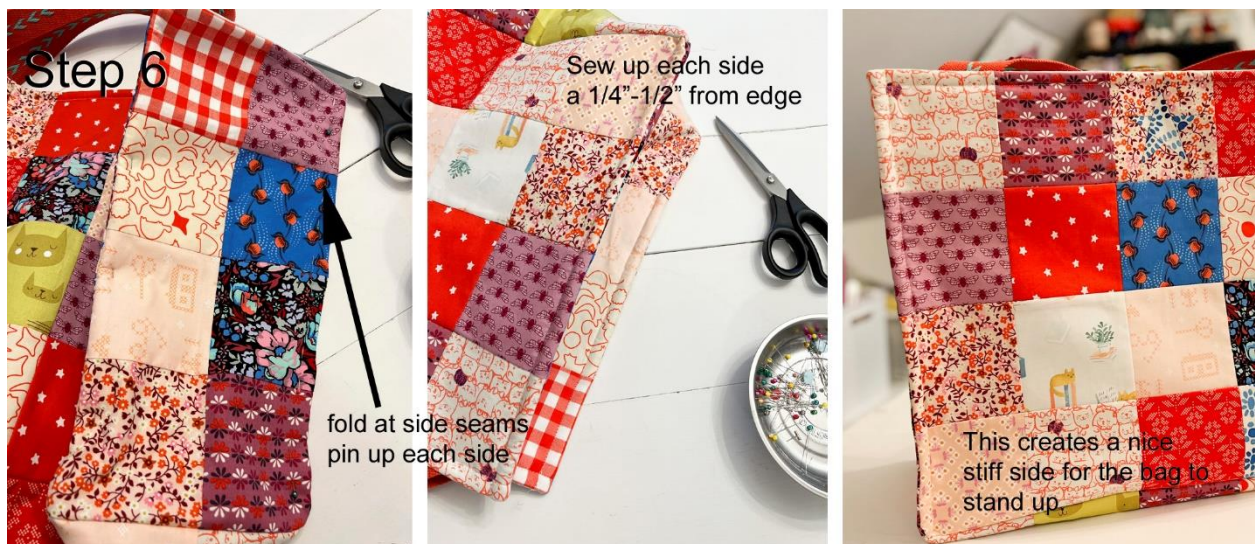

Ta Da!! You have a finished giant tote to hold all those projects, or all the groceries, or as a fun overnight bag. Share on Social Media with hashtags #woollypetaltutorials and #woollypetalsprojecttote

---